



9/16" BORE BRASS MINIMATIC® CYLINDER

9PS-3/4

Mount: Body* **Available Stroke Lengths:** 3/4"
Type: Single Acting Non-Rotating Shaft
 Spring Return

Add **-N** to the end of the part number for a non-threaded rod
 *Super Structure recommended

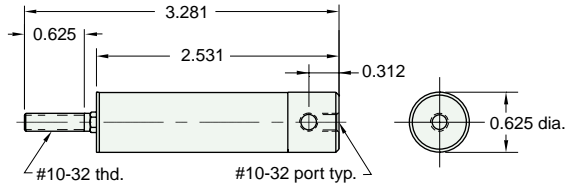

Rod nut included, but not shown on drawing

9BS-□

Stroke Length "L"	3/4"	1 1/2"	2 1/4"	3"
Stroke Length "A"	2.750	4.218	5.593	6.937
	2.312	3.750	5.125	6.500

To order: Add stroke length to the end of the part number

Add **-T** to the end of the part number after stroke for a #10-32 x 1/2" rod thread

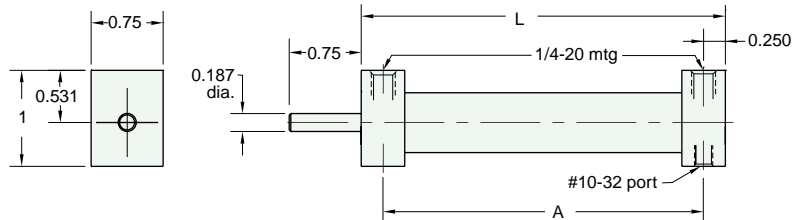

9SS-□

Stroke Length "L"	3/4"	1 1/2"	2 1/4"	3"
Stroke Length "L"	3.031	4.531	5.875	7.250

To order: Add stroke length to the end of the part number

Add **-T** to the end of the part number after stroke for a #10-32 x 1/2" rod thread

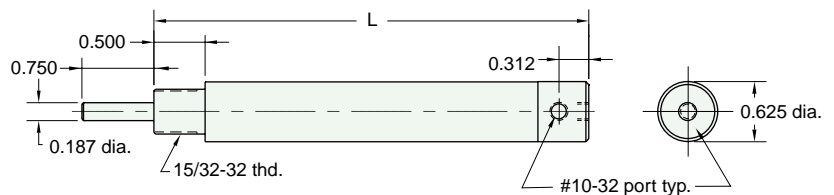

Rod nut included, but not shown on drawing

Note: On 3/4" stroke rod is hexagonal stainless steel (non-rotating) and threaded #10-32 x 5/8

9CS-□

Stroke Length "L"	3/4"	1 1/2"	2 1/4"	3"
Stroke Length "L"	3.343	4.687	6.062	7.406

To order: Add stroke length to the end of the part number

Add **-T** to the end of the part number after stroke for a #10-32 x 1/2" rod thread

